

VENTILATION

換気

“鶏舎内に適切な風を確実に送り、舎内の空気を交換する”これがテクノ社の主要目標の1つです。

換気は、風を横に抜く方法、あるいは縦方向に抜く方法等が考えられます。テクノ社が提供する大型ファンは、低燃費でかつ十分な風を確実に送り、交換してくれます。

VENTILATION

Ensuring adequate airing and change of air inside each individual shed is one of the primary objectives of TECNO IMPIANTI AVICOLI.

Based on different requirements, it is possible to choose between a transverse or a longitudinal type ventilation.

The high capacity fans can ensure sufficient change of air, with a low consumption of electrical energy.

FAN MODEL	HP	Air Capacity MC				
		0	10	20	30	40
ED24	0.5	11950	11200	10450	9900	9500
EM30	0.75	16150	15640	14880	14450	13940
	0.5	15560	15130	14280	13940	13430
EM36	0.75	22250	21585	20450	19835	18650
	0.5	19800	19210	18350	17800	16600
EM48	1.5	40800	38800	36240	34730	33300
	1	36550	34760	32470	31110	29835

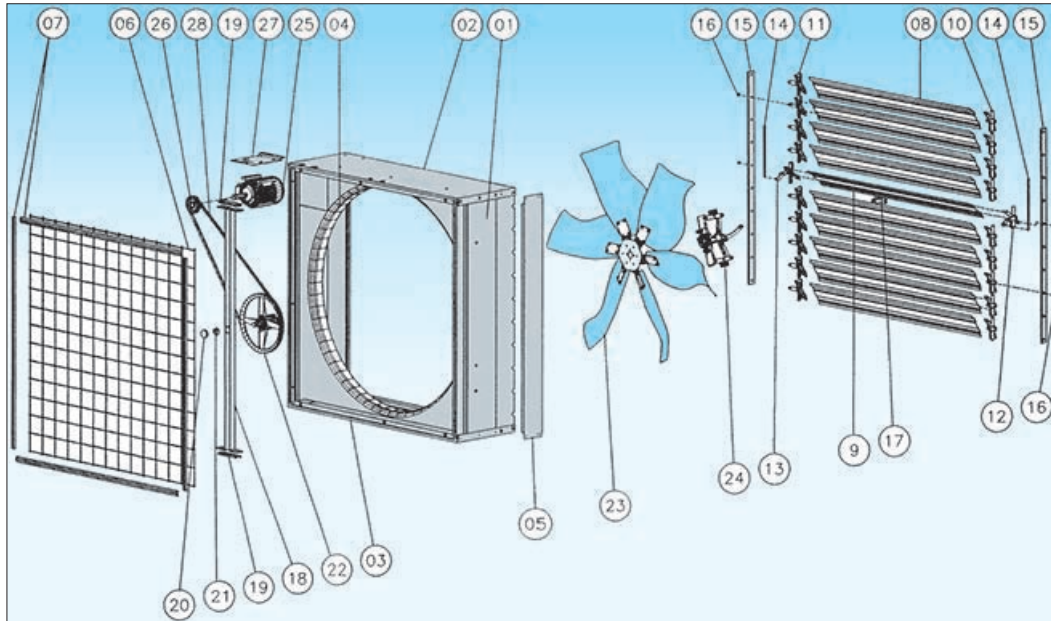
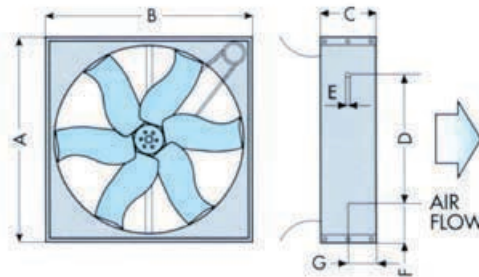

- 01 Galvanized side panel
- 02 Galvanized top panel
- 03 Galvanized bottom panel
- 04 Venturi
- 05 Galvanized cover plate
- 06 Safety mesh guard
- 07 Fixing strips for safety guard
- 08 Galvanized shutter blade
- 09 Galvanized central shutter blade
- 10 Left side shutter bearing assembly
- 11 Right side shutter bearing assembly
- 12 Left side central shutter bearing assembly
- 13 Right side central shutter bearing assembly
- 14 Spring
- 15 Galvanized tierod with holes
- 16 Stop collar ϕ 7x17
- 17 Central shutter blade fork
- 18 Galvanized propeller central support
- 19 Distance piece
- 20 Calotte cover nut
- 21 Nut M25x10
- 22 Complete central pulley
- 23 Stainless steel propeller / precoated and galvanized propeller
- 24 Complete centrifugal system
- 25 Electric motor
- 26 Motor pulley
- 27 Galvanized sliding plate for motor
- 28 Notched belt section AX

お問い合わせ先

(株)日本シェーバー
 〒425-0002 静岡県焼津市吉津622
 TEL 054-627-0017 FAX 054-629-5041

JAPAN SHAVER LTD.

622 Yoshizu

Yaizu, 425-0002 Japan

Phone (81)54-627-0017 Fax (81)54-629-5041